

GRAPHIC SCALE

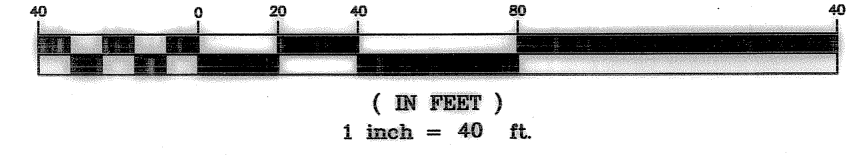

LEGEND

- PROPOSED FIRE HYDRANT
- SUBDIVISION MONUMENT TO BE SET
- PROPERTY BOUNDARY
- CENTERLINE
- RIGHT-OF-WAY LINE
- LOT LINE
- SECTION LINE
- SETBACK LINE
- PUBLIC UTILITY & LOT DRAINAGE EASEMENT
- FRONT LOT LINE EASEMENT IS 10'
- REAR LOT LINE EASEMENT IS 7.5'
- INTERIOR LOT LINE EASEMENT IS 7.5'
- PROPERTY CORNER
- STREET ADDRESS

"Utilities shall have the right to install, maintain and operate their equipment above and below ground and all other related facilities within the Public Utility Easements identified on this plat map as may be necessary or desirable in providing utility services within and without the lots identified herein, including the right of access to such facilities and the right to require removal of any obstructions including structures, trees and vegetation that may be placed within the PUE. The utility may require the lot owner to remove all structures within the PUE at the lot owner's expense, or the utility may remove such structures at the lot owner's expense. At no time may any permanent structures be placed within the PUE or any other obstruction which interferes with the use of the PUE without the prior written approval of the utilities with facilities in the PUE."

CURVE TABLE					
CURVE	RADIUS	LENGTH	DELTA	CHORD	CHORD DIR.
C1	28.00	44.16	90°21'39"	39.72	N45°01'18"E
C2	28.00	43.81	89°38'21"	39.47	N44°58'42"W
C3	28.00	36.12	73°54'17"	33.66	S53°14'59"W
C4	55.00	16.27	16°57'05"	16.21	N24°46'23"E
C5	55.00	140.72	146°35'51"	105.36	S73°27'09"E
C6	55.00	85.66	89°13'56"	77.26	S44°27'44"W

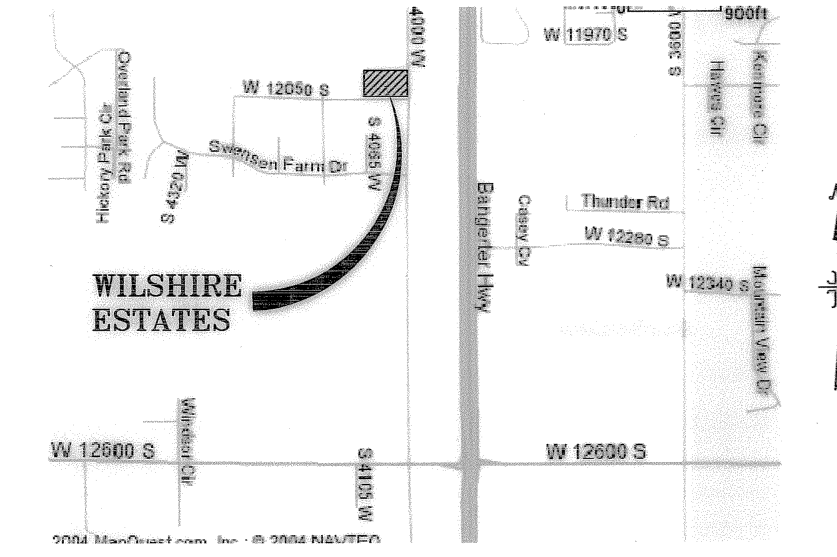

SURVEYOR'S CERTIFICATE

I, C. DAVID MCKINNEY DO HEREBY CERTIFY THAT I AM A PROFESSIONAL LAND SURVEYOR, AND THAT I HOLD CERTIFICATE NO. 5251295 AS PRESCRIBED UNDER THE LAWS OF THE STATE OF UTAH. I FURTHER CERTIFY BY AUTHORITY OF THE OWNERS, I HAVE MADE A SURVEY OF SAID TRACT OF LAND SHOWN ON THIS PLAT AND DESCRIBED BELOW, AND HAVE SUBDIVIDED SAID TRACT OF LAND INTO LOTS, STREETS, AND EASEMENTS AND THAT THE SAME HAS BEEN CORRECTLY SURVEYED AND STAKED ON THE GROUND AS SHOWN ON THIS PLAT AND THAT THIS IS TRUE AND CORRECT.

C. DAVID MCKINNEY
LIC. 5251295

DATE

BOUNDARY DESCRIPTION

A PARCEL OF LAND LYING WITHIN THE NORTHEAST QUARTER OF SECTION 30, TOWNSHIP 3 SOUTH, RANGE 1 WEST, SALT LAKE BASE & MERIDIAN, SALT LAKE COUNTY, UTAH MORE PARTICULARLY DESCRIBED AS:

BEGINNING AT A POINT SOUTH 0°09'32" EAST 33.00 FEET AND NORTH 89°50'28" WEST 33.00 FEET, AND SOUTH 0°09'32" EAST 1074.31 FEET FROM THE NORTHEAST CORNER OF SECTION 30, TOWNSHIP 3 SOUTH, RANGE 1 WEST, SALT LAKE BASE AND MERIDIAN; SAID POINT BEING ON THE WESTERLY RIGHT OF WAY LINE OF 4000 WEST STREET; AND BEING IN THE CENTER OF MIDAS WASH, AND RUNNING THENCE SOUTH 0°09'32" EAST, A DISTANCE OF 277.70 FEET, ALONG SAID RIGHT OF WAY; THENCE NORTH 89°47'53" WEST, A DISTANCE OF 435.60 FEET; THENCE SOUTH 0°09'32" EAST, A DISTANCE OF 117.17 FEET; THENCE NORTH 89°42'00" WEST ALONG THE NORTHERN BOUNDARY OF SWENSEN FARMS SUBDIVISION, A DISTANCE OF 104.40 FEET; THENCE NORTH 0°09'32" WEST ALONG THE EASTERN BOUNDARY OF SILVERCREST SUBDIVISION, A DISTANCE OF 467.96 FEET, TO THE CENTER OF MIDAS WASH; THENCE ALONG SAID MIDAS WASH THE FOLLOWING ELEVEN COURSES; NORTH 82°20'47" EAST, A DISTANCE OF 21.41 FEET; THENCE SOUTH 77°19'15" EAST, A DISTANCE OF 39.20 FEET; THENCE NORTH 83°45'39" EAST, A DISTANCE OF 62.24 FEET; THENCE NORTH 86°55'47" EAST, A DISTANCE OF 44.33 FEET; THENCE SOUTH 89°06'34" EAST A DISTANCE OF 103.56 FEET; THENCE NORTH 58°40'27" EAST, A DISTANCE OF 56.69 FEET; THENCE NORTH 76°20'51" EAST, A DISTANCE OF 65.59 FEET; THENCE SOUTH 58°24'15" EAST, A DISTANCE OF 69.14 FEET; THENCE SOUTH 70°58'33" EAST, A DISTANCE OF 76.10 FEET; THENCE SOUTH 19°12'17" EAST, A DISTANCE OF 59.159 FEET; THENCE SOUTH 59°47'40" EAST, A DISTANCE OF 9.93 FEET TO THE POINT OF BEGINNING.

CONTAINS 205,841 sq.ft. OR 4.726 acres.

OWNER'S DEDICATION

Known all men by these presents that _____, the _____ undersigned owner () of the above described tract of land, having caused same to be subdivided into lots and streets to be hereafter known as the _____

do hereby dedicate for perpetual use of the public all parcels of land shown on this plat as intended for Public Use in witness whereof _____ have hereunto set _____ this _____ day of _____ A.D., 20____.

ACKNOWLEDGMENT

STATE OF UTAH }
COUNTY OF SALT LAKE } S.S.

On the _____ day of _____ A.D., 20____, personally appeared before me, the undersigned Notary Public, in and for said County of Salt Lake in said State of Utah, the signer () of the above Owner's dedication _____ in number, who duly acknowledged to me that _____ signed it freely and voluntarily and for the uses and purposes therein mentioned. MY COMMISSION EXPIRES: _____

NOTARY PUBLIC
RESIDING IN SALT LAKE COUNTY

PLANNING COMMISSION

APPROVED THIS _____ DAY OF _____ A.D., 20____ BY THE COUNTY PLANNING AND ZONING COMMISSION.

WILSHIRE HILLS SUBDIVISION

CONTAINING 10 LOTS, AND 4.726 ACRES
LOCATED IN THE NORTHEAST 1/4 OF SECTION 30 TOWNSHIP 3 SOUTH, RANGE 1 WEST, SLB&M, SALT LAKE COUNTY, UTAH

RIVERTON CITY SALT LAKE COUNTY, UTAH

RECORDED # 10019768

STATE OF UTAH, COUNTY OF SALT LAKE, RECORDED AND FILED AT THE REQUEST OF
DATE _____ TIME _____ BOOK _____ PAGE _____

CLERK SALT LAKE COUNTY RECORDER

<p>Architecture Landscape Architecture Land Planning Engineering Surveying Interior Design</p>	<p>BOARD OF HEALTH</p> <p>APPROVED THIS 4th DAY OF April A.D., 2006 BY THE BOARD OF HEALTH</p>	<p>COMCAST</p> <p>APPROVED THIS 4th DAY OF April A.D., 2006 BY COMCAST</p>	<p>QUESTAR GAS</p> <p>APPROVED THIS 5th DAY OF April A.D., 2006 BY QUESTAR GAS</p>	<p>QWEST COMMUNICATIONS</p> <p>APPROVED THIS 6th DAY OF April A.D., 2006 BY QWEST COMMUNICATIONS</p>	<p>PACIFICORP</p> <p>APPROVED THIS 4th DAY OF April A.D., 2006 BY PACIFICORP</p>	<p>SOUTH VALLEY SEWER DISTRICT</p> <p>APPROVED THIS 23 DAY OF January A.D., 2007 BY THE IMPROVEMENT DISTRICT</p>
	<p>RIVERTON CITY ENGINEER</p> <p>I HEREBY CERTIFY THAT THIS OFFICE HAS EXAMINED THIS PLAT AND IT IS CORRECT IN ACCORDANCE WITH INFORMATION ON FILE IN THIS OFFICE.</p>	<p>APPROVAL AS TO FORM</p> <p>APPROVED AS TO FORM THIS 20th DAY OF Feb. A.D., 2007</p>	<p>RIVERTON CITY STREET LIGHTING</p> <p>APPROVED THIS _____ DAY OF _____ A.D., 20____ BY RIVERTON CITY</p>	<p>RIVERTON CITY</p> <p>PRESENTED TO THE RIVERTON CITY THIS 27 DAY OF Feb A.D., 2007 AT WHICH TIME THIS SUBDIVISION WAS APPROVED AND ACCEPTED</p>	<p>RECORDED # 10019768</p> <p>STATE OF UTAH, COUNTY OF SALT LAKE, RECORDED AND FILED AT THE REQUEST OF</p>	